

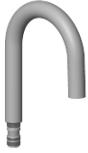















90 28 22 215 01 Produktversion ab 01.04.2025



	Champagne (22kt Gold)	90 28 22 215 01-47
	Chrom	90 28 22 215 01-00
	Platin gebürstet	90 28 22 215 01-06
	Platin	90 28 22 215 01-08
	Weiß matt	90 28 22 215 01-10
	Dark Brass matt	90 28 22 215 01-16
	Dark Bronze matt	90 28 22 215 01-17
	Dark Chrome	90 28 22 215 01-19
	Light Gold gebürstet	90 28 22 215 01-27
	Messing gebürstet (23kt Gold)	90 28 22 215 01-28
	Schwarz matt	90 28 22 215 01-33
	Dark Brass gebürstet	90 28 22 215 01-39
	Bronze gebürstet	90 28 22 215 01-42
	Champagne gebürstet (22kt Gold)	90 28 22 215 01-46
	Chrom gebürstet	90 28 22 215 01-93
	Dark Platinum gebürstet	90 28 22 215 01-99



Auslauf 100 mm, 7 l/min. - Champagne (22kt Gold)

ERSATZTEILE

90 28 22 215 01 Produktversion ab 01.04.2025



Auslauf 100 mm, 7 l/min. - Champagne (22kt Gold)

ERSATZTEILE

90 28 22 215 01 Produktversion ab 01.04.2025

90 28 22 215 01 Produktversion ab 01.04.2025

Ersatzteile für die
anderen
Oberflächenvarianten
finden Sie hier:
Chrom

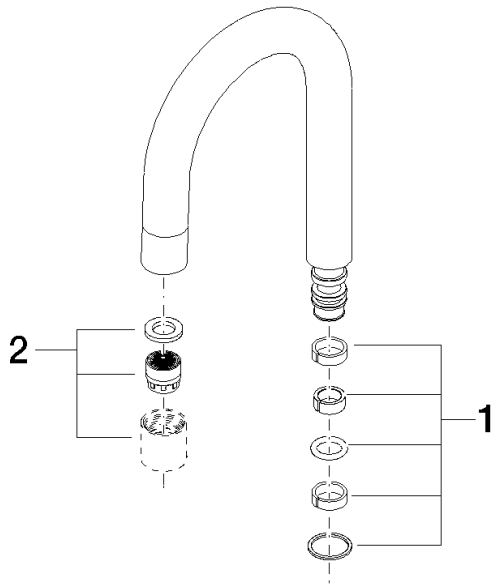

Ersatzteilstückliste

Nr.	Artikelnummer	Benennung	Verbaumenge	Lieferzeit
2	90 23 01 028 03-47	Luftsprudler M18xIG 7,0 l/min. - Champagne (22kt Gold)	1,00	30
1	90 14 15 020 01 90	Dichtungssatz Auslauf 10 x 10 x 2 mm -	1,00	2