

# Classic 3

C3NN200 / C3NF200 / C3NC210 / C3NC200 / C3NC240



DE Montageanleitung  
EN Installation instructions  
FR Instruction de montage

**Achtung!** Gläser niemals ungeschützt auf den Boden stellen. Verletzung der Glaskante führt zu Glasbruch.

**Caution!** Never put glass walls on the floor without protection. Damaging the glass edges results in breaking of the glass.

**Attention!** Jamais placer des parois de douche en verre au sol sans protection. Des verres endommagés casseront.

Mögliche Einsatzgebiete des Elements WDX200:  
(MAL = Montageanleitung)

Nische, WDX200+WDXAN1928

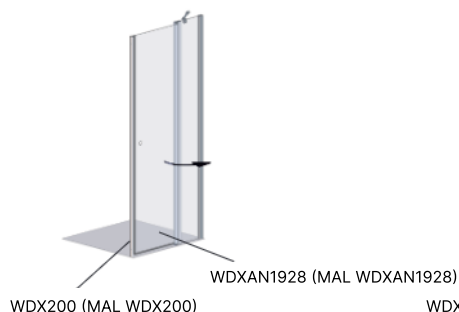

Fronteinstieg, WDX200+WDX900

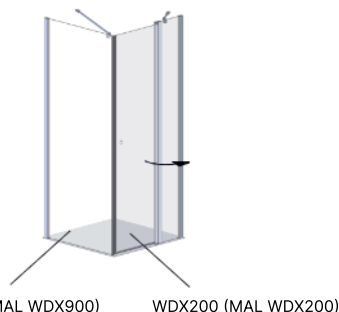

Eckeinstieg, 2x WDX200 oder WDX100+WDX200

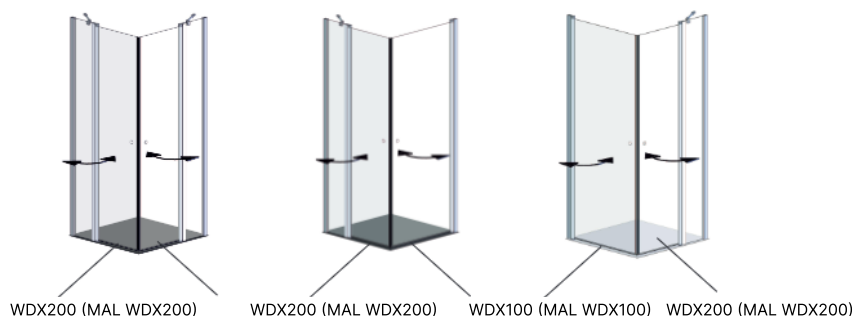

Die abgebildeten Formen der Profile und Griffe dienen der schematischen Darstellung und entsprechen nicht dem tatsächlichen Lieferumfang!

Mitgeliefertes Montagematerial  
supplied assembly material  
matériaux pour assemblage

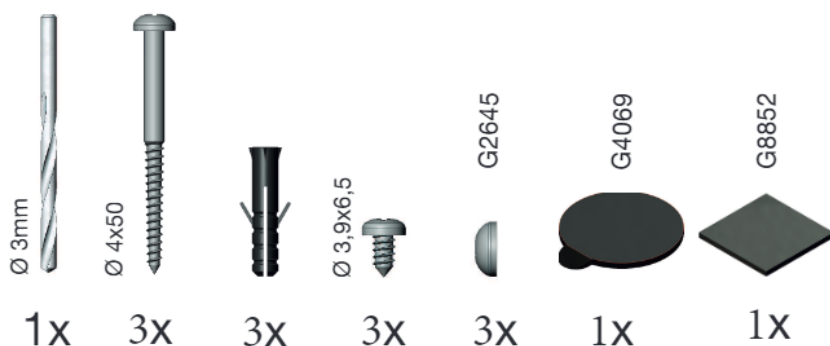

Zum Aufbau benötigen Sie  
For mounting you need  
Pour l'installation il vous faut



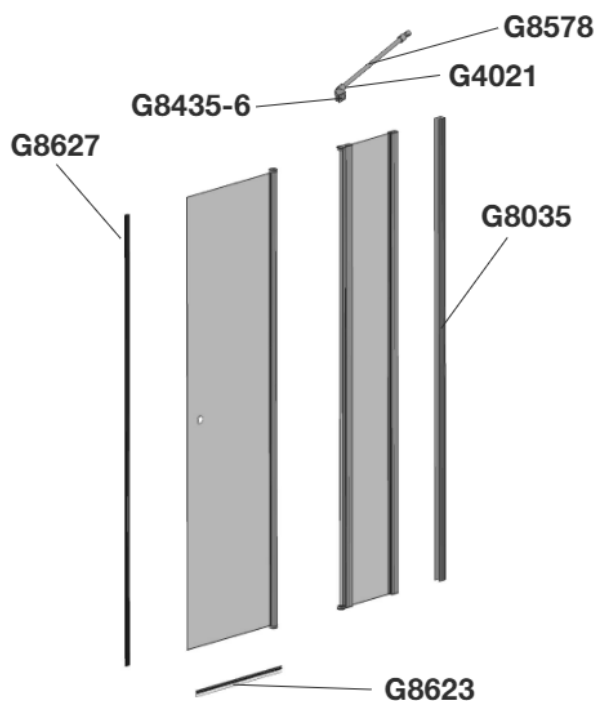

①

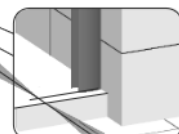
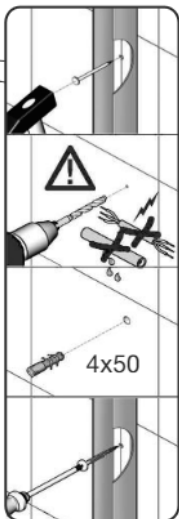
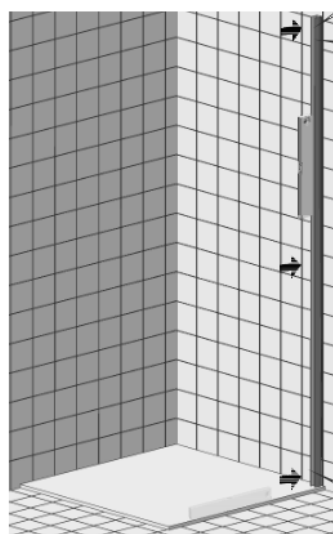

Montageanleitung für Rechtsanschlag  
(Linksanschlag = spiegelbildlich)

Assembly instructions for righthand mounting  
(left hand mounting = mirror inverted)

instruction d'assemblage pour charnière à droite  
(à gauche = inversé latéralement)

20mm

②

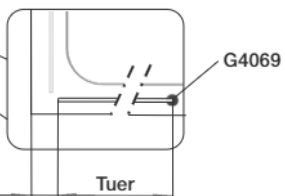
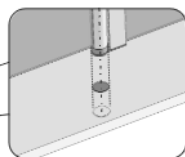
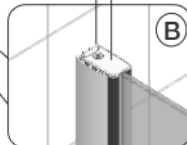
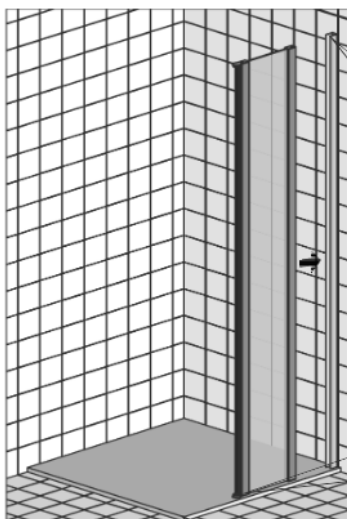
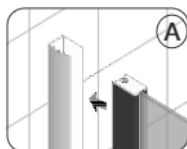

③

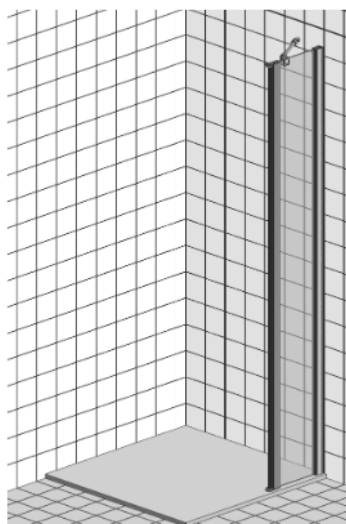
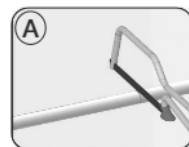

ca. 150 mm

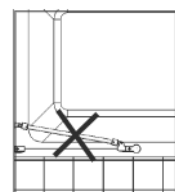
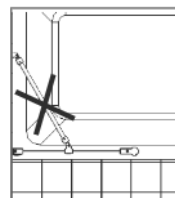
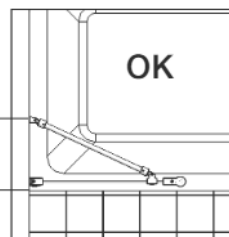

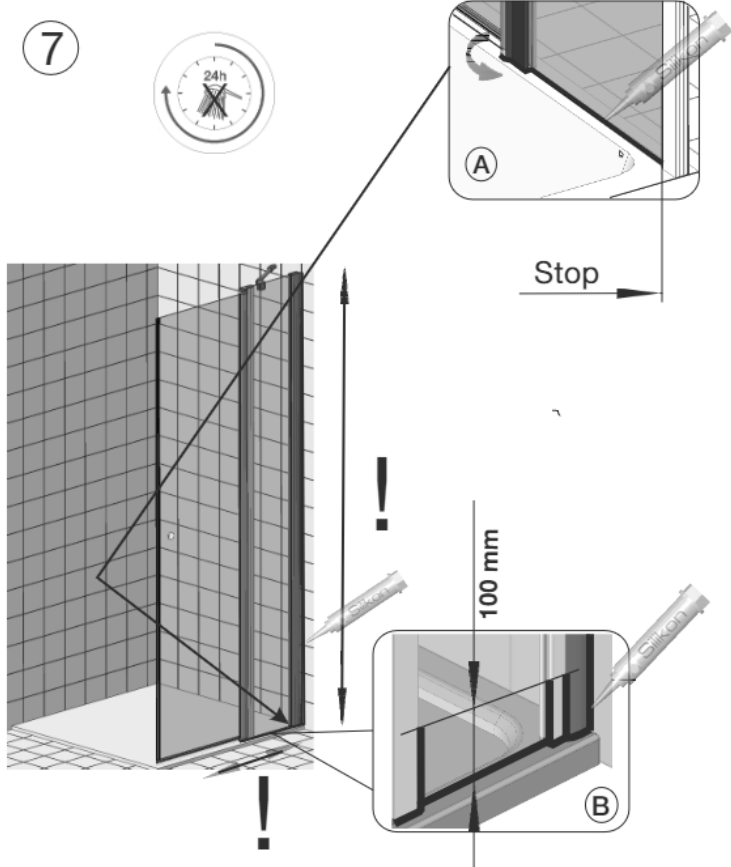
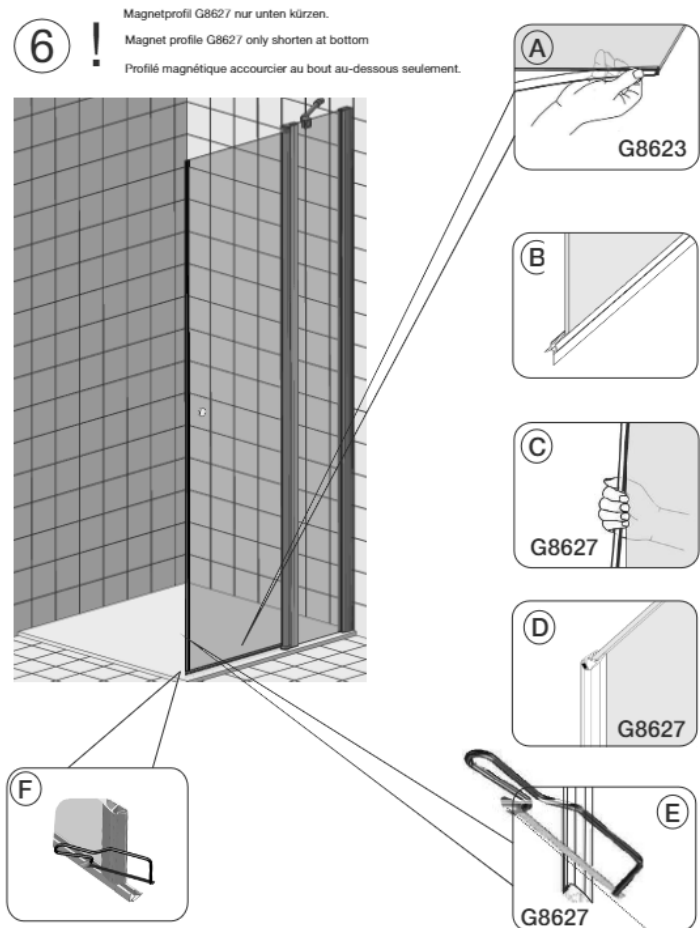
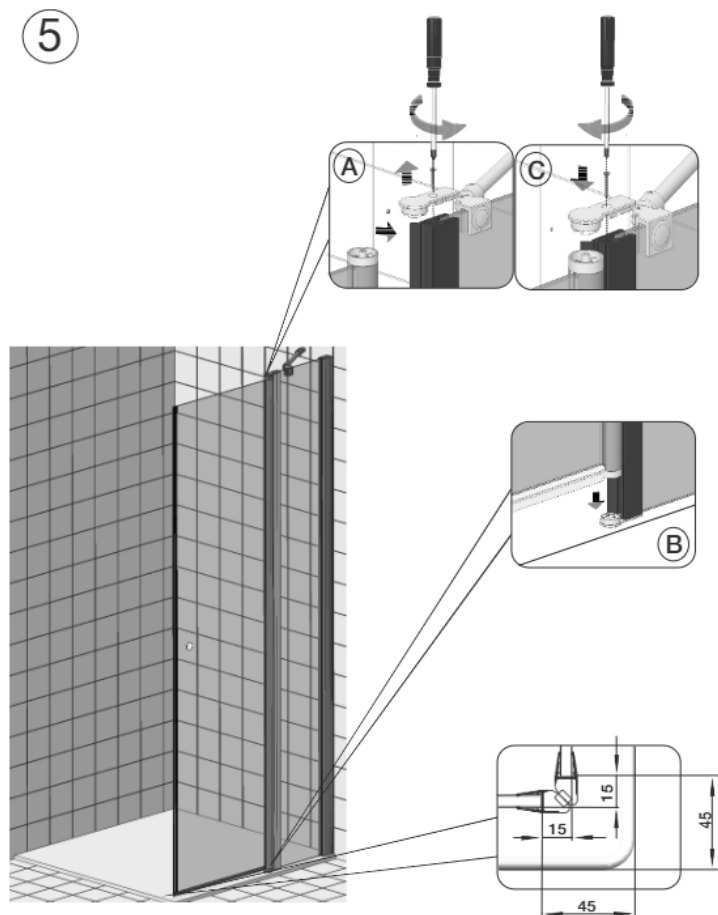
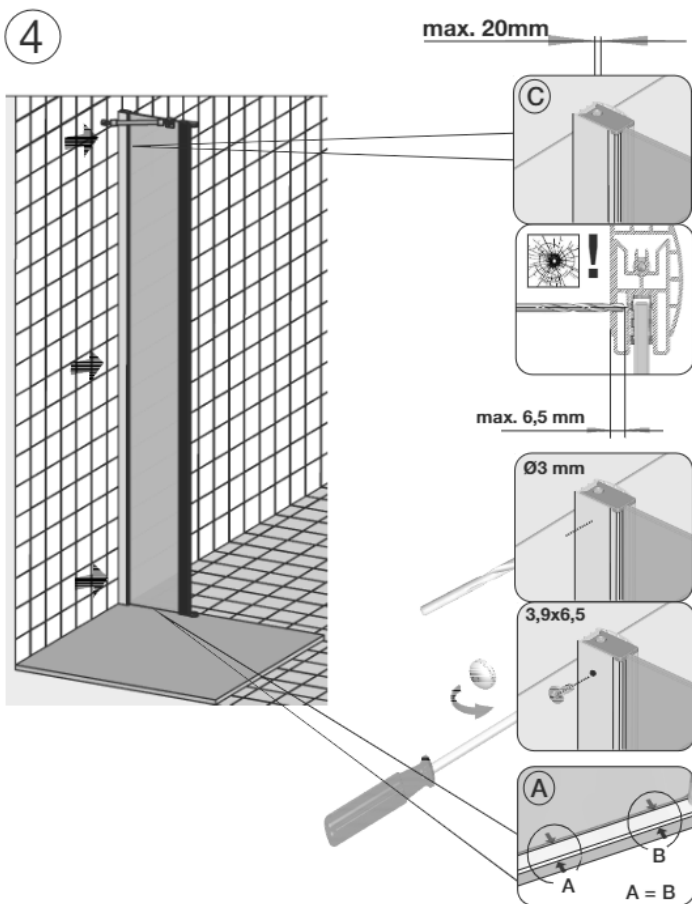

The diagram shows two cross-sectional views of door profiles. The left view is for WDX100/200/300/400, showing a profile with a central cavity and a magnetic strip on the bottom. The right view is for WDX110, showing a profile with a central cavity and a magnetic strip on the bottom. Both profiles are shown with a hatched background representing the door structure.

WDX100/200/300/400

WDX100/200/300/400

Drehsäule: max. 20 mm  
Magnetprofil: max. 10 mm

WDX110

Wandanschlußprofil mit Drehsäule  
Verstellbereich 15 mm pro Seite

**Montage auf Duschkboden**

**Montage Bodeneben**

DT	DT-EBM	BE-EBM
800	785-805	755-775
900	885-905	855-875
1000	985-1005	955-975
1200	1185-1205	1155-1175
1400	1385-1405	1355-1375

