









90 18 40 290 00

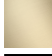

| | | |
|---|---|--------------------|
|  | Platin gebürstet | 90 18 40 290 00-06 |
|  | Chrom | 90 18 40 290 00-00 |
|  | Dark Chrome | 90 18 40 290 00-19 |
|  | Light Gold gebürstet | 90 18 40 290 00-27 |
|  | Messing gebürstet (23kt Gold) | 90 18 40 290 00-28 |
|  | Platin / Platin gebürstet | 90 18 40 290 00-36 |
|  | Messing / Messing gebürstet (23kt Gold) | 90 18 40 290 00-38 |
|  | Bronze gebürstet | 90 18 40 290 00-42 |
|  | Dark Platinum gebürstet | 90 18 40 290 00-99 |



Griff - Platin gebürstet

ERSATZTEILE

90 18 40 290 00



Griff - Platin gebürstet

ERSATZTEILE

90 18 40 290 00

90 18 40 290 00

Ersatzteile für die
anderen
Oberflächenvarianten
finden Sie hier:
Chrom

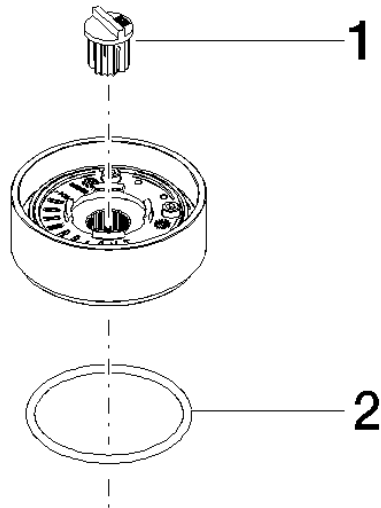

Ersatzteilstückliste

| Nr. | Artikelnummer | Benennung | Verbaumenge | Lieferzeit |
|-----|--------------------|--------------------------|-------------|------------|
| 1 | 09 12 12 216 90 | Rastbuchse - | 1,00 | 2 |
| 2 | 90 14 10 049 00 90 | O-Ring 45,69 x 2,62 mm - | 1,00 | 2 |