

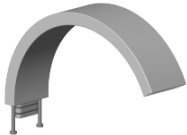







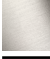

90 11 70 013 00



| | | |
|---|---|--------------------|
|  | Messing / Messing gebürstet (23kt Gold) | 90 11 70 013 00-38 |
|  | Chrom | 90 11 70 013 00-00 |
|  | Platin gebürstet | 90 11 70 013 00-06 |
|  | Dark Chrome | 90 11 70 013 00-19 |
|  | Light Gold gebürstet | 90 11 70 013 00-27 |
|  | Messing gebürstet (23kt Gold) | 90 11 70 013 00-28 |
|  | Platin / Platin gebürstet | 90 11 70 013 00-36 |
|  | Bronze gebürstet | 90 11 70 013 00-42 |
|  | Champagne gebürstet (22kt Gold) | 90 11 70 013 00-46 |
|  | Champagne (22kt Gold) | 90 11 70 013 00-47 |
|  | Dark Platinum gebürstet | 90 11 70 013 00-99 |



Auslauf - Messing / Messing gebürstet (23kt Gold)

ERSATZTEILE

90 11 70 013 00



Auslauf - Messing / Messing gebürstet (23kt Gold)

ERSATZTEILE

90 11 70 013 00

90 11 70 013 00

Ersatzteile für die
anderen
Oberflächenvarianten
finden Sie hier:
Chrom

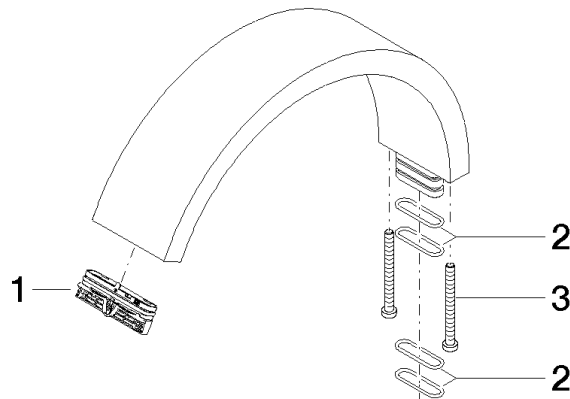

Ersatzteilstückliste

| Nr. | Artikelnummer | Benennung | Verbaumenge | Lieferzeit |
|-----|--------------------|--|-------------|------------|
| 3 | 09 30 30 092 90 | Befestigung Zylinderschraube mit Innensechskant niedriger Kopf M4 x 40 mm - | 2,00 | 2 |
| 1 | 90 29 03 121 00 90 | Luftsprudler - | 1,00 | 2 |
| 2 | 09 14 10 096 90 | O-Ring EPDM 70 17,0 x 1,5 mm - | 4,00 | 2 |