

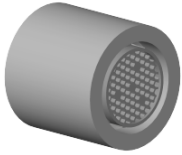









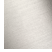





90 23 01 019 00 Produktversion ab 01.04.2025



	Chrom gebürstet	90 23 01 019 00-93
	Chrom	90 23 01 019 00-00
	Platin gebürstet	90 23 01 019 00-06
	Platin	90 23 01 019 00-08
	Weiß matt	90 23 01 019 00-10
	Dark Brass matt	90 23 01 019 00-16
	Dark Bronze matt	90 23 01 019 00-17
	Dark Chrome	90 23 01 019 00-19
	Light Gold gebürstet	90 23 01 019 00-27
	Messing gebürstet (23kt Gold)	90 23 01 019 00-28
	Schwarz matt	90 23 01 019 00-33
	Dark Brass gebürstet	90 23 01 019 00-39
	Bronze gebürstet	90 23 01 019 00-42
	Champagne gebürstet (22kt Gold)	90 23 01 019 00-46
	Champagne (22kt Gold)	90 23 01 019 00-47
	Cyprum	90 23 01 019 00-49
	Dark Platinum gebürstet	90 23 01 019 00-99



Luftsprudler M18x1-IG 7,0 l/min. - Chrom gebürstet

ERSATZTEILE

90 23 01 019 00 Produktversion ab 01.04.2025



Luftsprudler M18x1-IG 7,0 l/min. - Chrom gebürstet

ERSATZTEILE

90 23 01 019 00 Produktversion ab 01.04.2025

90 23 01 019 00 Produktversion ab 01.04.2025

Ersatzteile für die
anderen
Oberflächenvarianten
finden Sie hier:
Chrom

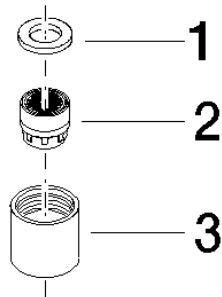

Ersatzteilstückliste

Nr.	Artikelnummer	Benennung	Verbaumenge	Lieferzeit
1	90 14 05 020 00 90	Dichtung 16,7 x 10,0 x 2,0 mm -	1,00	2
3	09 23 01 019-93	Luftsprudlerhülse Ø 21 x 20 mm - Chrom gebürstet	1,00	20
2	90 29 03 057 00 90	Luftsprudlereinsatz -	1,00	2